

DRAWN S. ESTES	APPROVAL B. TOEPFER	DATE FIRST DRAWN 02-23-99	SCALE 1 : 1
-------------------	------------------------	------------------------------	----------------

CUSTOMER TYCO STANDARD

TOLERANCE UNLESS SPECIFIED OTHERWISE	0.X = +/-.1	[.254]
	0.XX = +/-.01	[.254]
	0.XXX = +/-.010	[0.25]
	ANGLES = +/-.1°	

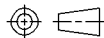

DO NOT SCALE THIS DRAWING

CHANGES			
REV.	DATE	CO	APP.
△	03-25-99	REDRAWN	S.E. B.T.
△			

ELECTRICAL CHARACTERISTICS: (ALL DATA APPLIES @ 23°C UNLESS OTHERWISE SPECIFIED)

COIL DATA:

NOMINAL VOLTAGE:	12 VDC
OPERATE VOLTAGE:	7.2 VDC MAXIMUM
RELEASE VOLTAGE:	1.2 VDC MINIMUM
COIL RESISTANCE:	79.5 OHMS ±10%
OPERATE TIME:	8 mSEC MAXIMUM EXCLUDING BOUNCE
RELEASE TIME:	8 mSEC MAXIMUM EXCLUDING BOUNCE
TEMPERATURE RANGE:	STORAGE -40°C. TO +155°C
	OPERATE -40°C. TO +85°C
	OPERATE -40°C. TO +125°C (APPLICATION DEPENDENT)

CONTACT DATA: (CONTACT DATA IS FORMATTED N.O./N.C.)

CONTACT ARRANGEMENT:	1 FORM C (SPDT)
CONTACT MATERIAL:	AgNi 0.15 (FINE GRAIN SILVER)
CONTACT MILLIVOLT DROP:	200 mV @ 40A ON N.O. CONTACTS (AFTER SWITCHING)
	250 mV @ 30A ON N.C. CONTACTS (AFTER SWITCHING)

MAXIMUM MAKE CURRENT:	120A/45A (LAMP) @ 16 VDC
MAXIMUM BREAK CURRENT:	60A/40A @ 16 VDC RESISTIVE
MAXIMUM CONTINUOUS CURRENT:	60A/40A @ 23°C, 40A/30A @85°C
INITIAL BREAKDOWN VOLTAGE:	500V RMS CONTACTS TO COIL

EXPECTED LIFE: 100,000 OPERATIONS, 40A, 14 VDC RESISTIVE ON NORMALLY OPEN CONTACT

MECHANICAL CHARACTERISTICS:

EXPECTED LIFE: 10 MILLION OPERATIONS, NO CONTACT LOAD, 20 OPERATIONS PER SECOND MAXIMUM

DRAWN S. ESTES	APPROVAL B. TOEPFER	DATE FIRST DRAWN 02-23-99	SCALE 1 : 1
-------------------	------------------------	------------------------------	----------------

CUSTOMER TYCO STANDARD

TOLERANCE	0.X =	+/- .1	[.254]
UNLESS	0.XX =	+/- .01	[.254]
SPECIFIED	0.XXX =	+/- .010	[0.25]
OTHERWISE	ANGLES =	+/- 1'	

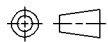

DO NOT SCALE THIS DRAWING

X.XXX = INCHES
[XX.XX] = MILLIMETERS

MARKING TO INCLUDE:

MANUFACTURER'S NAME, MANUFACTURER'S PART NUMBER, SCHEMATIC, COIL VOLTAGE, CONTACT RATING, COUNTRY OF ORIGIN, AND DATE CODE

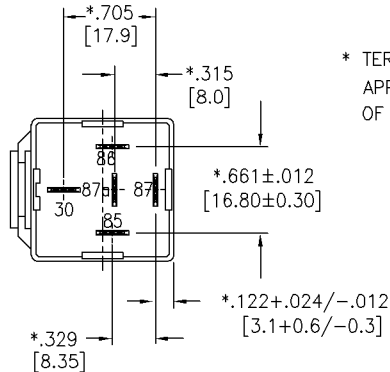
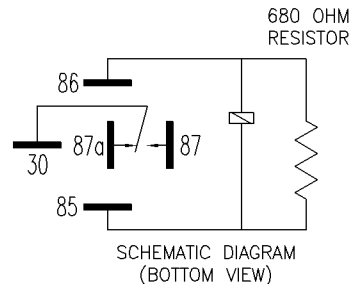
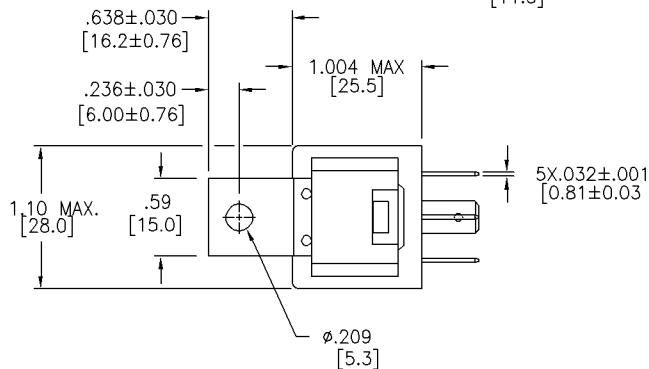
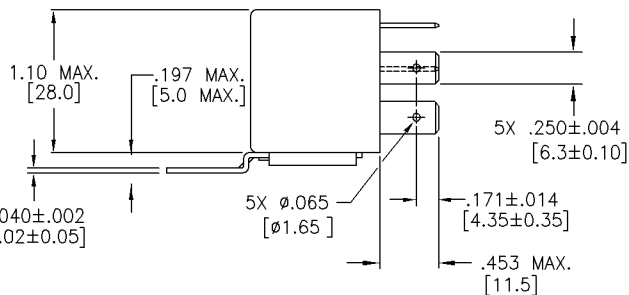

* TERMINAL LOCATIONS APPLY AT THE BASE OF THE TERMINALS